

2100 & 2200

Please turn to our **Company Profile** and **Level Switch Selection Guide** to learn more of the advantages in specifying **Thomas Products Ltd.** sensors.

FIXED SET POINTS, 9/16" - 18" UNF-2B, PLASTIC

Model 2100

Because we mold in-house, we can certify that our polysulfone flow switches use only virgin material and runners are not introduced nor have color concentrates been added during processing that can hinder FDA requirements or additive leaching.

Unique reverse taper design helps pass particulates.

Full size out port minimizes turbulence

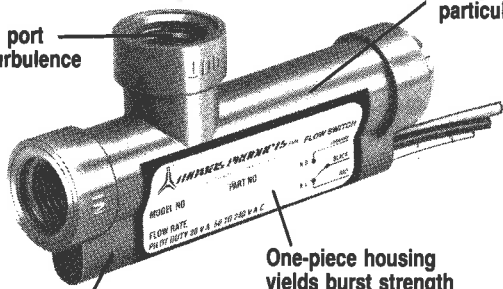

Large, full size reed switch silicone potted for shock and vibration deadening.

One-piece housing yields burst strength of 1500 ± PSI @ 70°.

Applications:

- Plastic configuration throughout.
- Rugged yet economical flow switch for monitoring liquid flow or no flow conditions.
- FDA Approved Polysulfone
- UL File No. E86797

Dimensional Data: Model 2100 & 2200

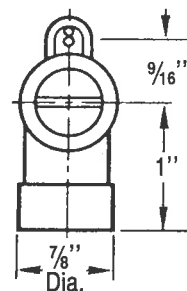
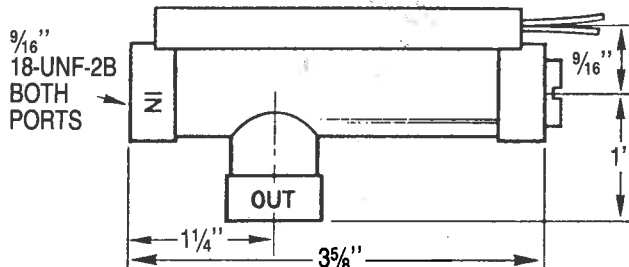

Specifications:

Housing	Piston	Spring	"O" Ring	Reed Switch	Wire	Oper. Temp.	Oper. Pres.	Set Pt. Accur.	Set Pt. Diff.
Polysulfone		316 SST	Viton "A"	20 Watt SPDT SPST See Note 6	18 AWG 24" Lg. Polymeric See Note 5	-20°F to +225°F	250 PSIG @ 70°F Max. See Note 7	15% MAX.	20% MAX.

Part No.

SIZE PORT	FLOW SETTING GPM <small>See Notes 1, 2, 8, 9</small>	P/N N.O. SPST SWITCH	P/N N.C. SPST SWITCH	P/N SPDT SWITCH
9/16" - 18	.1	12686	12695	12704
	.25	12687	12696	12705
	.5	12688	12697	12706
	.75	12689	12698	12707
	1	12690	12699	12708
	1.5	12691	12700	12709

Electrical:

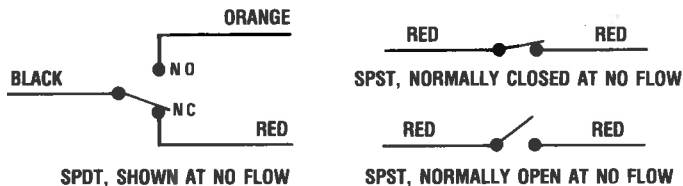

Pressure Drop ΔP:

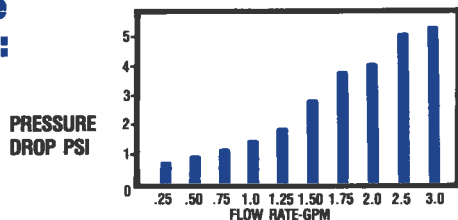

Switch Ratings... Max Resistive Load

V.A.	VOLTS	AMPS DC	AMPS AC	AMPS AC MAX
20	0-50	.4	.4	1.0
	120	.15	.16	
	240	.06	.08	

Switch Rating 20 VA: 50-240 VAC Pilot Duty

Specialty Options:

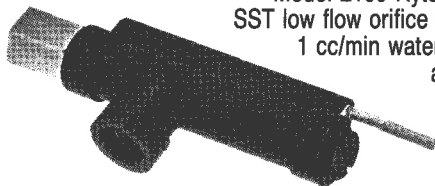

Model 2100 Ryton R4 with SST low flow orifice assembly, 1 cc/min water set point and cable.

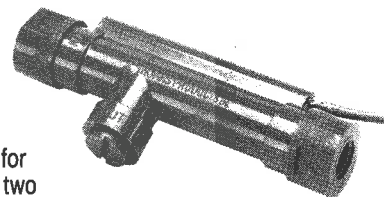

Model 2100 Modified for straight-thru flow and two 1/4" NPT adapters.